

R22 Series Medium Volume Stainless Steel Pressure Regulator

R22 Series Medium Volume Stainless Steel Pressure Regulator is using large area diaphragm structure with good output pressure stability and high sensitivity. Mainly used in a medium flow volume gas distribution system.

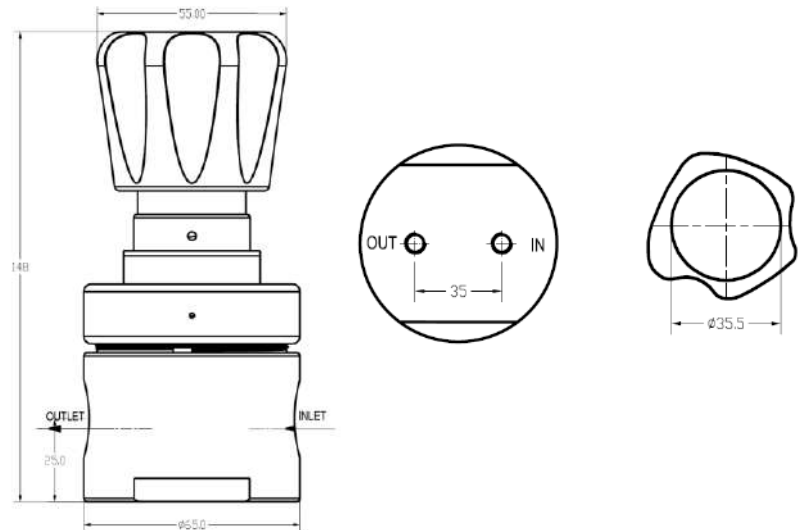

Product Features

- Large volume
- Compact design
- Large area metal diaphragm, Precision adjustment
- Metal seal between diaphragm and body
- Metal diaphragm ensures output stability and service life
- Multi-output pressure range
- Optional panel mount

Construction Materials

- Valve Body: SUS 316 / 316L
- Poppet : SUS 316 / 316L
- Valve Seat : PTFE / PCTFE
- Other Component : SUS 304



Operation Parameters

- Inlet Connections : 1/2" NPT
- Maximum input pressure : 500 / 3500 Psi
- Output pressure range : 0-50, 0-150, 0-250, 0-500 Psi
- Operation temperature : -40 ~ 74°C
- Leakage rate : 1×10^{-6} atm.cc/sec He
- Cv : 1.3

Flow Data

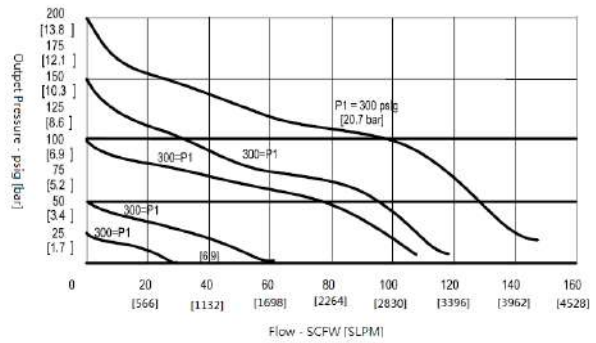
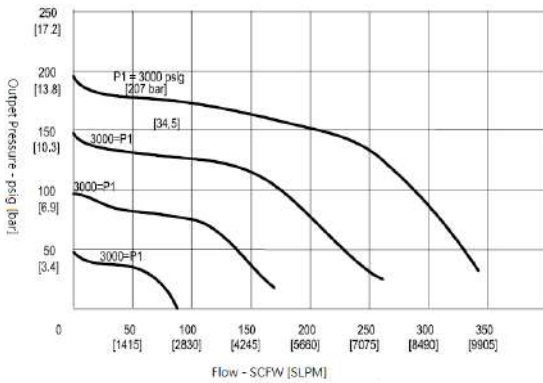

Ordering Information

Series	Seat Materials	Inlet Pressure	Outlet Pressure	Inlet Connections	Outlet Connections	Options
R22	P	A	D	00	00	P
	P:PTFE C:PCTFE	A: 3000 psi B: 500 psi	D: 50 psi E: 150 psi F: 250 psi	00: 1/2" NPT(F) 01: 1/2" NPT(M) 11: 1/2" LOK 12: 12MMLOK	00: 1/2" NPT(F) 01: 1/2" NPT(M) 11: 1/2" LOK 12: 12MMLOK	

